

Windows 10 wireless guide

Step 1: Click on the Wi-Fi icon on your Windows 10 taskbar - it should show available Wi-Fi connections. Click on **MDXUNI**.

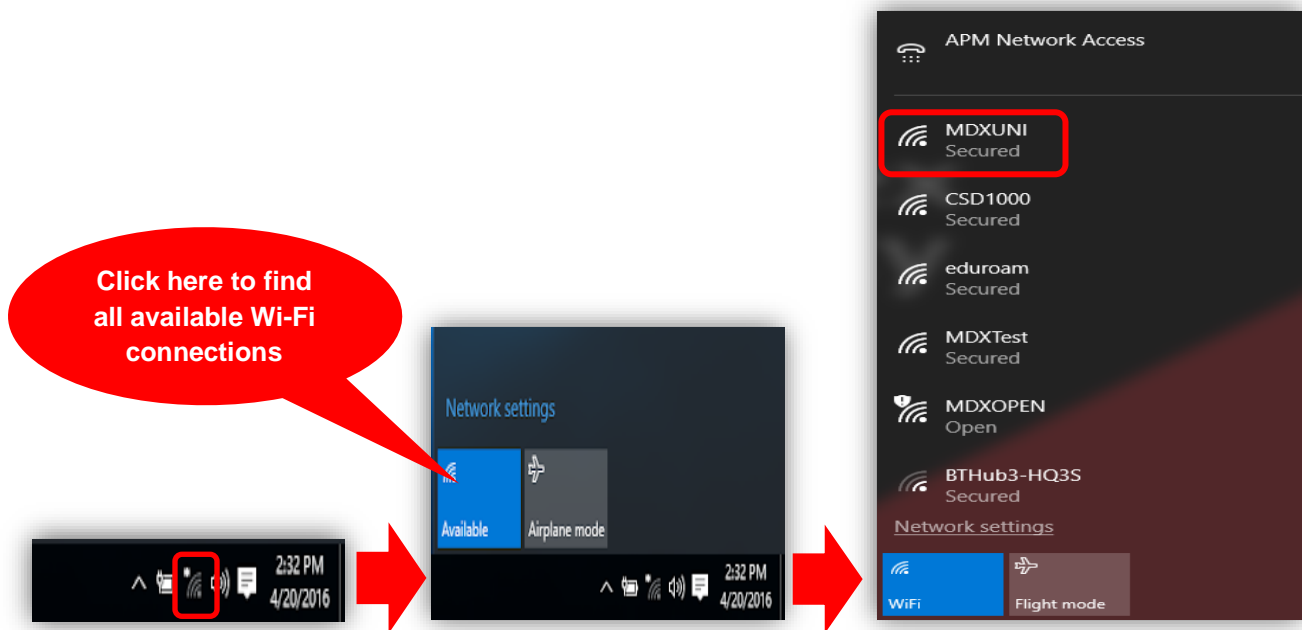

Step 2: Make sure the **Connect Automatically** box has been ticked, then click on the **Connect** button.

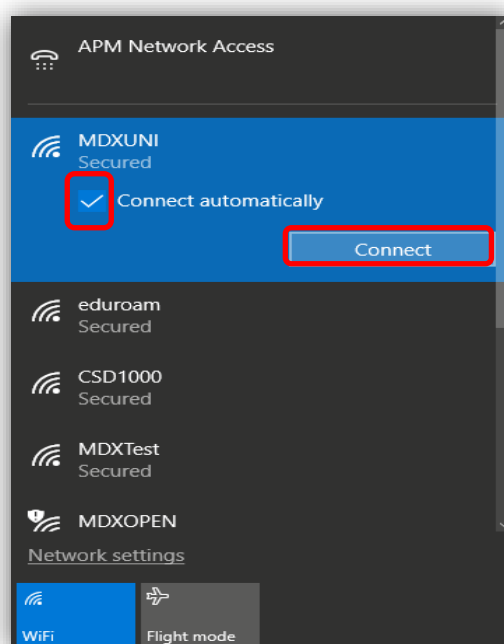

Step 3: Enter your Middlesex University student **Username e.g. AB123** and **Password**. Click **OK** and then click on the **Connect** button.

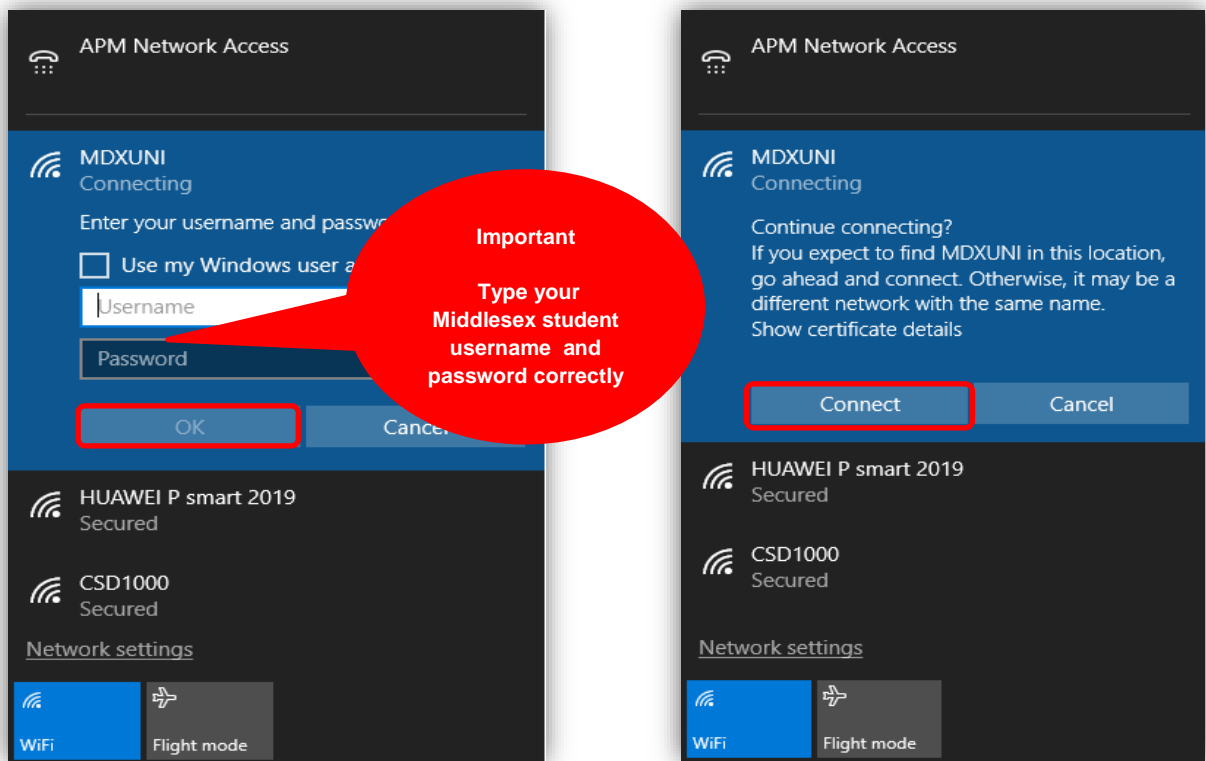

The Wi-Fi icon on the Windows 10 taskbar will then indicate successful connection.



You will now have access to the internet, as well as all university network resources.